



**Model Number**

CCB10-30GS60-E0

**Features**

- 10 mm flush
- Operating distance adjustable via potentiometer
- High EMC resistance
- Stainless steel version
- Operating voltage range 10 V ... 60 V DC

**Accessories**

BF 30  
Mounting flange, 30 mm

**Technical Data**

**General specifications**

Switching function	Normally open (NO)
Output type	NPN
Rated operating distance	$s_n$ 10 mm
Installation	flush
Output polarity	DC
Assured operating distance	$s_a$ 0 ... 8.1 mm
Output type	3-wire

**Nominal ratings**

<b>Installation conditions</b>	
A	0 mm
B	0 mm
C	20 mm
F	40 mm
Operating voltage	$U_B$ 10 ... 60 V DC
Switching frequency	f 0 ... 10 Hz
Reverse polarity protection	reverse polarity protected
Short-circuit protection	pulsing
Voltage drop	$U_d$ ≤ 2.8 V
Operating current	$I_L$ 0 ... 200 mA
Off-state current	$I_r$ 0 ... 0.5 mA typ. 0.1 µA at 25 °C
Off-state current $T_U = 40$ °C, switching element off	≤ 100 µA
No-load supply current	$I_0$ ≤ 20 mA
Time delay before availability	$t_v$ ≤ 50 ms
Switching state indicator	LED, yellow

**Functional safety related parameters**

MTTF <sub>d</sub>	760 a
Mission Time (T <sub>M</sub> )	20 a
Diagnostic Coverage (DC)	0 %

**Indicators/operating means**

Potentiometer	sensitivity adjustment
---------------	------------------------

**Ambient conditions**

Ambient temperature	-25 ... 70 °C (-13 ... 158 °F)
Storage temperature	-40 ... 85 °C (-40 ... 185 °F)

**Mechanical specifications**

Connection type	cable PVC , 2 m
Housing material	Stainless steel 1.4305 / AISI 303
Sensing face	PBT
Degree of protection	IP67

**Compliance with standards and directives**

<b>Standard conformity</b>	
Standards	EN 60947-5-2:2007 EN 60947-5-2/A1:2012 IEC 60947-5-2:2007 IEC 60947-5-2 AMD 1:2012

**Approvals and certificates**

UL approval	cULus Listed, General Purpose
CCC approval	Certified by China Compulsory Certification (CCC)

**Dimensions**

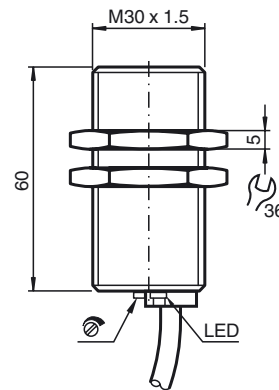

**Electrical Connection**

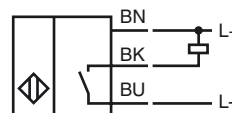

Installation Conditions

